

Survey for C.H. Greenwell in Sec^s 21-22-16-15. Tp. 6. N. R. 2. W.

see book page 5 for description

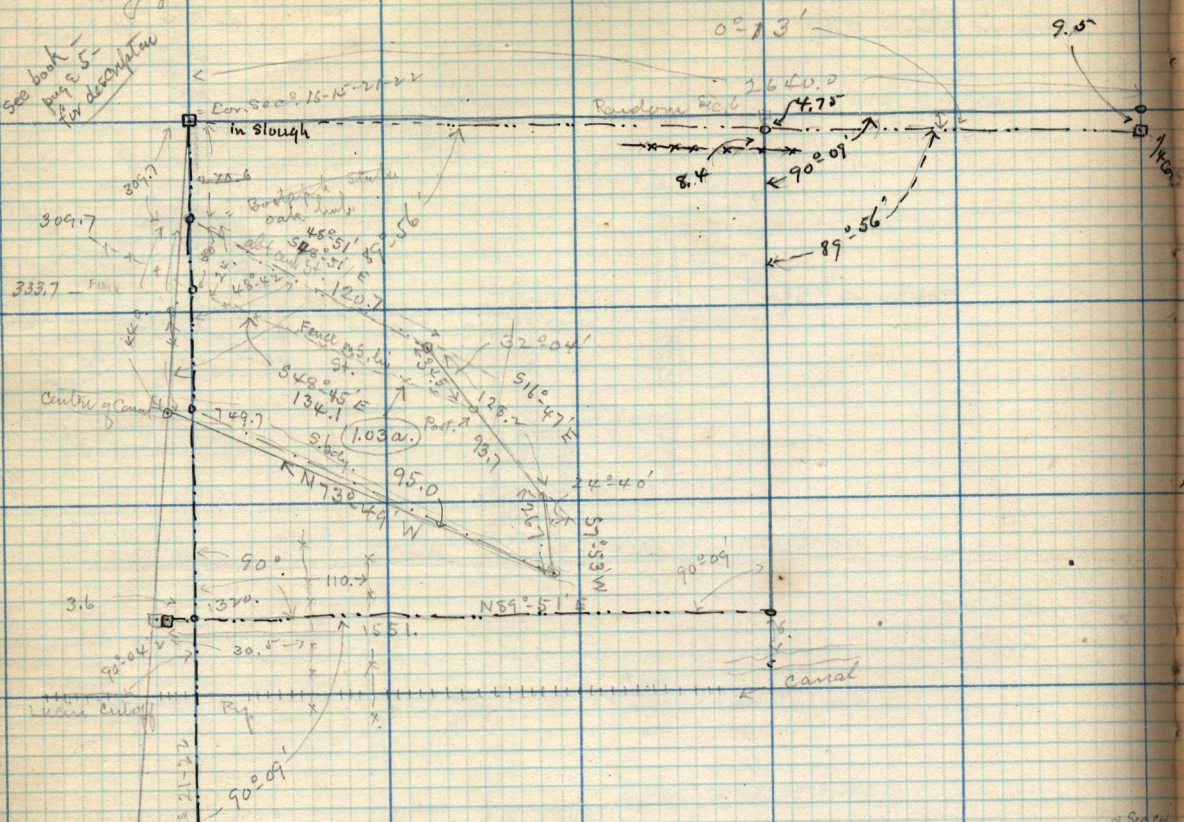

Traverse table, of above tract beg. at N.W. cor. at point 309.24

	N	S	E	W
S 48° 51' E		120.7	79.4	90.9
S 16° 47' E		128.2	122.7	37.0
S 7° 53' W		267.0	264.4	36.6
N 73° 49' W	95.0			91.3
North	440.0			
	466.5	466.5	127.9	127.9

traverse of this South part of the above tract South of the fence on the S. line of the tract as shown beg. at N.W. cor. at point 333.7 feet S. of the Sec. W.

	N	S	E	W
S 48° 45' E		134.1	83.4	100.8
S 16° 47' E		93.7	89.7	27.1
S 7° 53' W		267.0	264.4	36.6
N 73° 49' W	95.0			91.3
North	416.0			
	442.5	442.5	127.9	127.9

